

Anatomy of a Create 2

You have your Create 2 in your hands and you want to learn more about what's in front of you. Or perhaps you've been playing around with the Create 2 and aren't sure where to drill/cut/solder.

This document is to help you understand the modules that make up the robot and where to access them.

Table of Contents

- General Anatomy
- Screw Boss Location
- Drill Template for Faceplate Modification
- Modules & Sensors
- Buttons & Lights

STEM Subject(s):

General technical comprehension

Experience Level:

Advanced

Supplies:

- iRobot Create 2

Additional Resources

- [Create 2 OI Spec](#)
- [Drill Template](#)
- [Deco Cover Modification](#)

Robot Anatomy

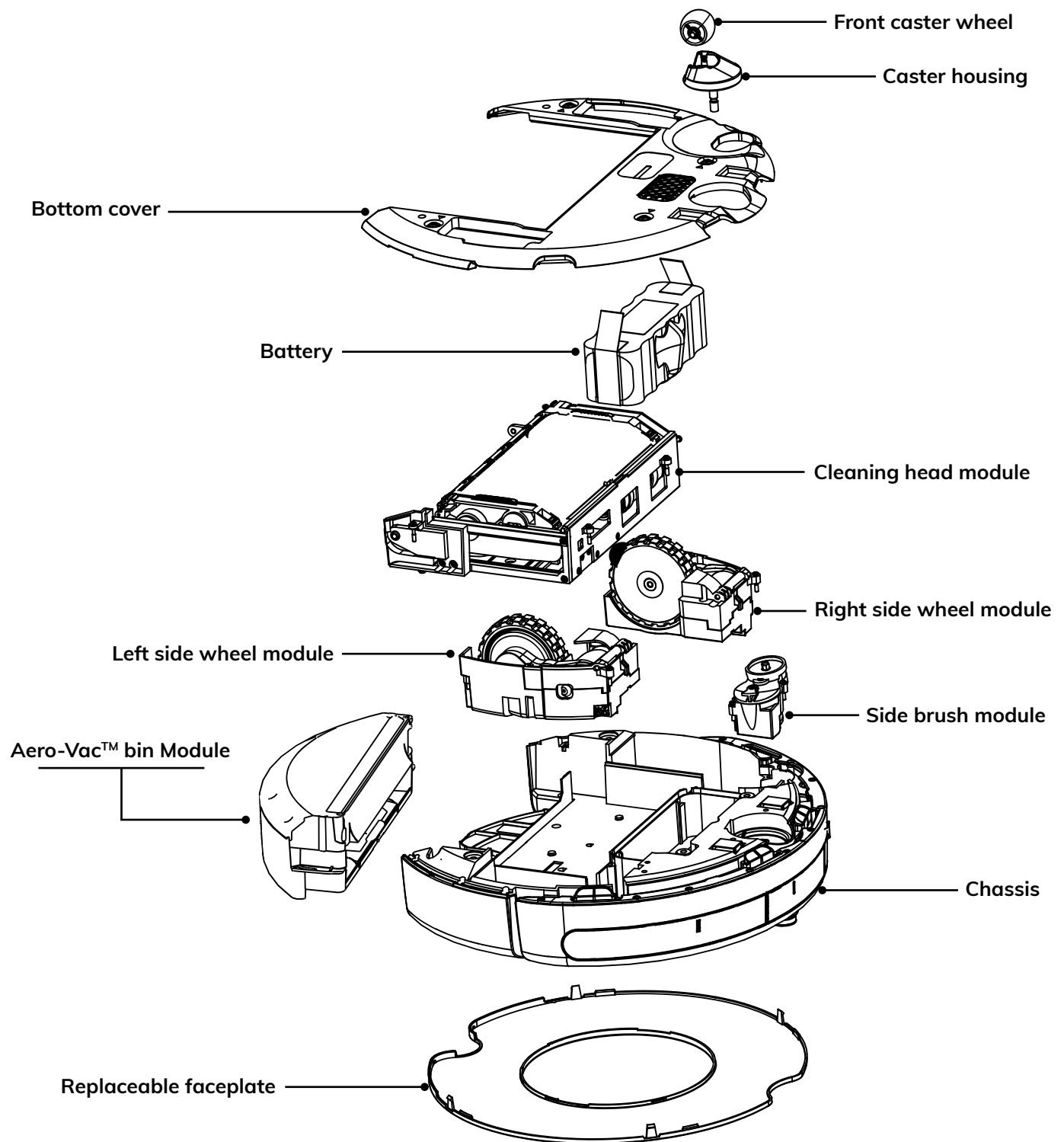

Screw Boss Materials

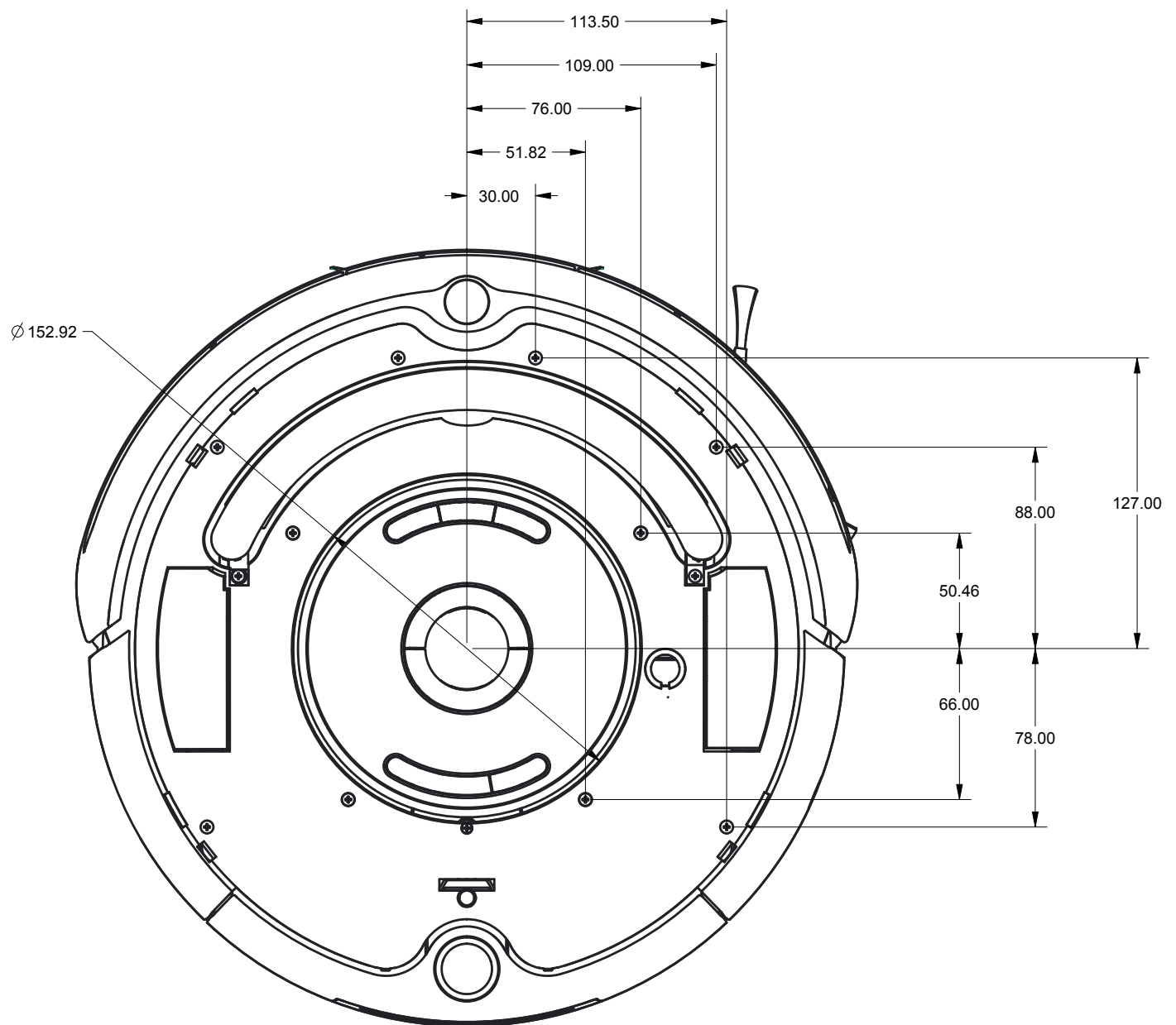

Robot Anatomy

Want to mount something on top of the robot, or perhaps access the serial port? You can access the to-scale [drill template here](#). If you're looking for instructions into how to mount features and add wire routing holes, you can access the [Deco Modification document here](#).

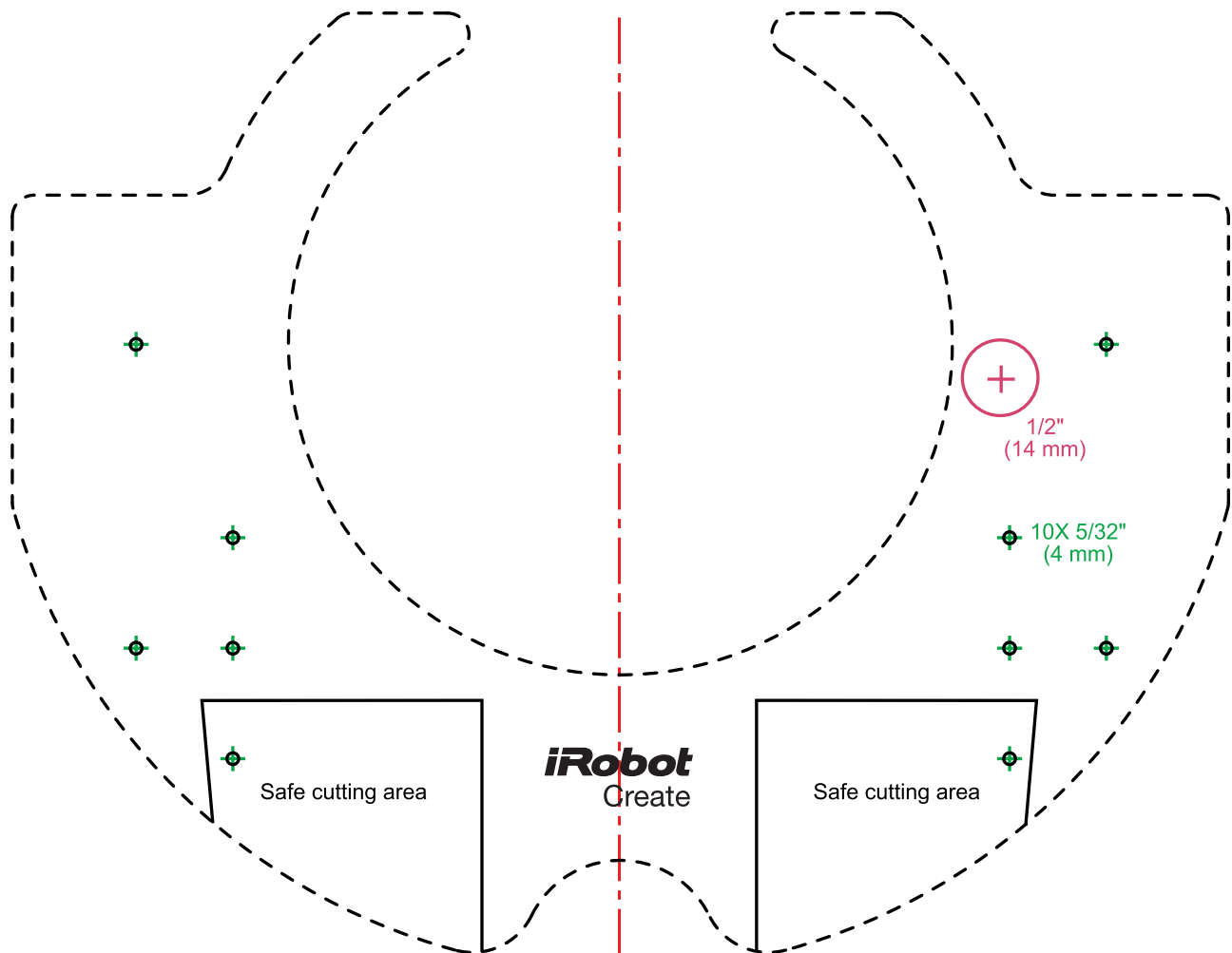

The template displayed on this page is for reference only — It is not sized for use.

Modules & Sensors — Top

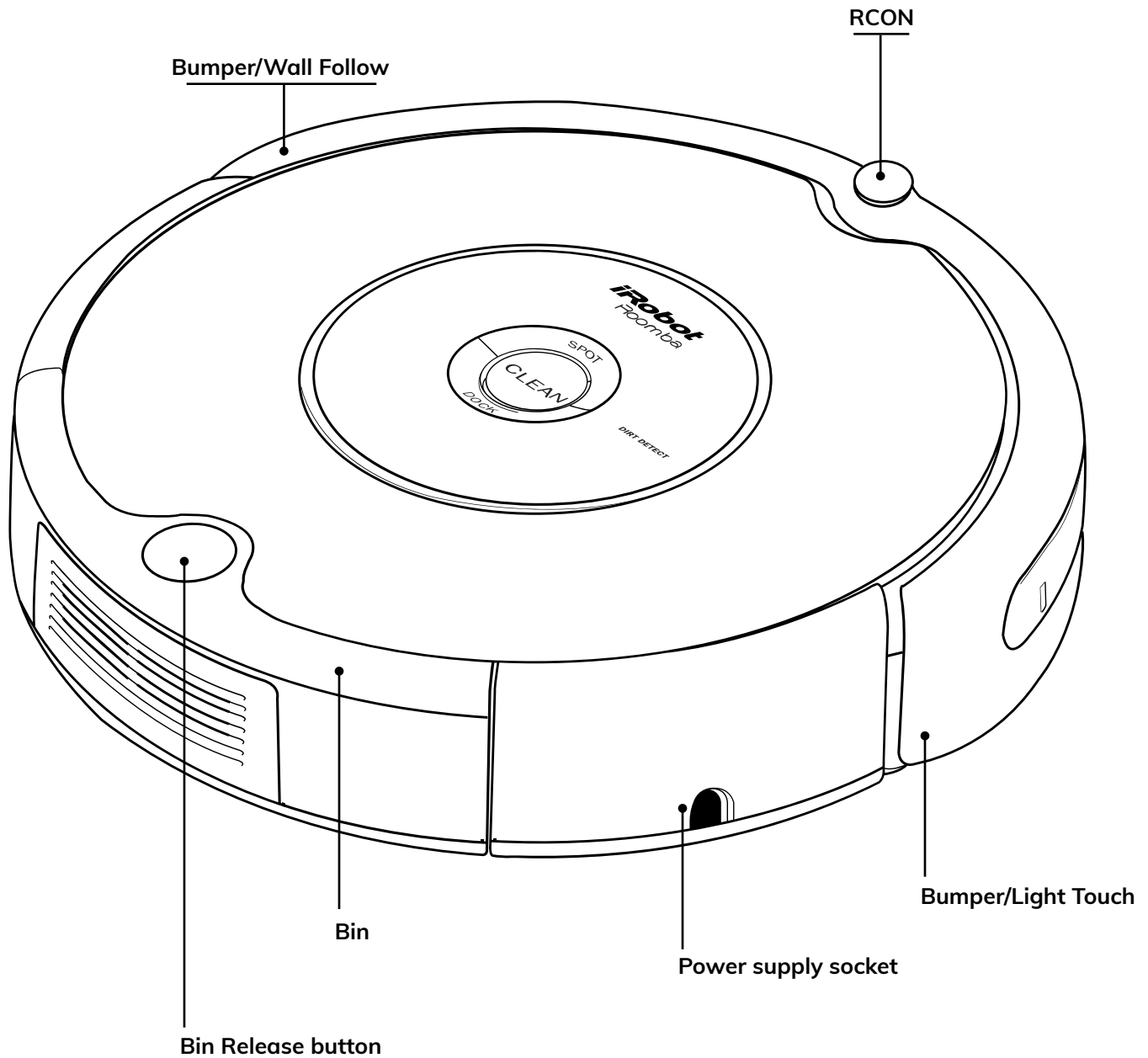

Modules & Sensors — Underside

Infrared Cliff Sensors

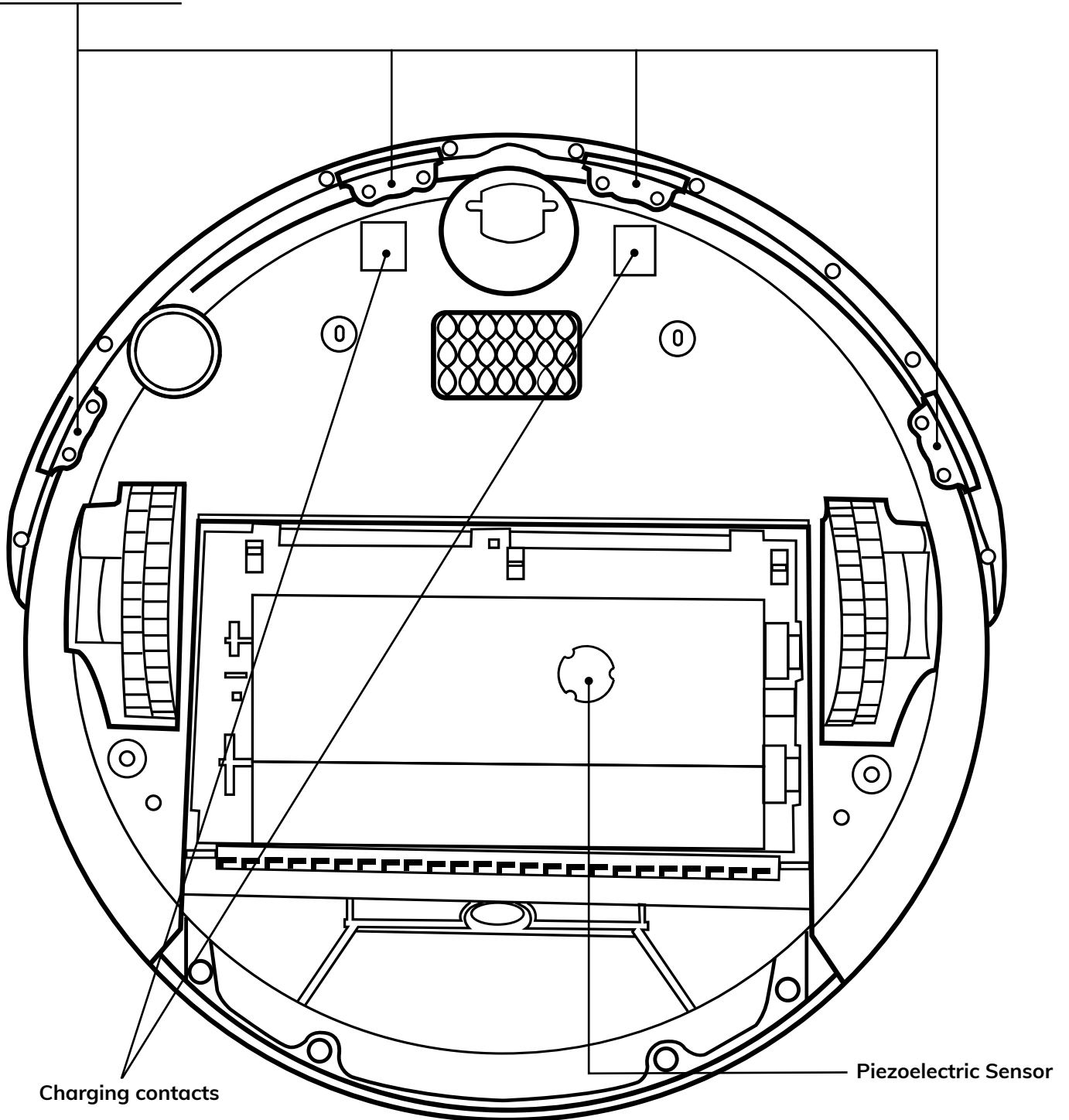

Buttons & Lights

